

Licensing Sub-Committee Report

Item No:	<input type="text"/>
Date:	<input type="text"/>
Licensing Ref No:	16/01043/LIPN - New Premises Licence
Title of Report:	Essentials Unit 1 Leicester Square Station Charing Cross Road
Report of:	Director of Public Protection and Licensing
Wards involved:	St James's
Policy context:	City of Westminster Statement of Licensing Policy
Financial summary:	None
Report Author:	Mrs Sumeet Anand-Patel Senior Licensing Officer
Contact details	Telephone: 020 7641 2737 Email: sanandpatel@westminster.gov.uk

1. Application

1-A Applicant and premises			
Application Type:	New Premises Licence, Licensing Act 2003		
Application received date:	27 January 2016		
Applicant:	Global VIPs Limited		
Premises:	Essentials		
Premises address:	Unit 1 Leicester Square Station Charing Cross Road London	Ward:	St James's
		Cumulative Impact Area:	West End
Premises description:	This premises currently operates as a newsagent and the applicant is seeking permission to sell alcohol for consumption off the premises		
Premises licence history:	This premises has not benefitted from a premises licence under the Licensing Act 2003.		
Applicant submissions:	None		

Sale by retail of alcohol				On or off sales or both:			Off
Day:	Mon	Tues	Wed	Thur	Fri	Sat	Sun
Start:	11:00	11:00	11:00	11:00	11:00	11:00	11:00
End:	22:00	22:00	22:00	22:00	22:00	22:00	22:00
Seasonal variations:	N/A						
Non-standard timings:	N/A						

Hours premises are open to the public							
Day:	Mon	Tues	Wed	Thur	Fri	Sat	Sun
Start:	07:00	07:00	07:00	07:00	07:00	07:00	07:00
End:	22:00	22:00	22:00	22:00	22:00	22:00	22:00
Seasonal variations:	N/A						
Non-standard timings:	N/A						
Adult Entertainment:	N/A						

2. Representations

2-A Responsible Authorities	
Responsible Authority:	Environmental Health
Representative:	Maxwell Koduah
Received:	4 th February 2016
Status:	Withdrawn

I refer to the application for a New Premises Licence number for the above premises, which is located in the West End Cumulative Impact area.

This representation is based on a plan dated January 2016 submitted with the operating schedule.

The applicant is seeking the following licensable activities:

1. Supply of Alcohol for 'Off' the premises, Monday to Sunday from 11:00 to 22:00 hours.

I wish to make the following representations:

1. The Supply of Alcohol 'Off' the premises and for the hours requested may have the effect of increasing Public Nuisance in the area and impact on Public Safety.

Conditions have been offered in the operating schedule and these are under consideration.

The applicant is asked to contact the undersigned to arrange a site visit to assess the premises and ensure the premises is satisfactory and following this, additional conditions may be recommended to Environmental Health to support the licensing objectives Prevention of Public Nuisance and Public Safety.

The granting of the new premises licence as presented would have the likely effect of causing an increase in Public Nuisance and may impact on Public Safety within the West End Cumulative Impact area.

Note: Following agreement to conditions with the applicant, attached at Appendix 4, Environmental Health have withdrawn their representation.

Responsible Authority:	Metropolitan Police Service
Representative:	PC Mike Day
Received:	18 th February 2016

With reference to the above application, I am writing to inform you that the Metropolitan Police, as a responsible authority, will be making a representation. It is our belief that if granted the application would undermine the Licensing Objectives.

The venue is situated within the West End Cumulative Impact Area, a locality where this is traditionally high crime and disorder. There are major concerns that this application will cause further policing problems for the Metropolitan Police, British Transport Police and Transport for London in an already demanding area and add to the cumulative impact.

Note: The Metropolitan Police have also provided statements from British Transport Police and the TFL Station Supervisor. These are attached at Appendix A2.

3. Policy & Guidance

The following policies within the City Of Westminster Statement of Licensing Policy apply:

Policy HRS1 applies:	(i) Applications for hours within the core hours set out below in this policy will generally be granted, subject to not being contrary to other policies in the Statement of Licensing Policy.
-----------------------------	--

	(ii) Applications for hours outside the core hours set out below in this policy will be considered on their merits, subject to other relevant policies.
Policy CIP1 applies:	<p>(i) It is the Licensing Authority's policy to refuse applications in the Cumulative Impact Areas for: pubs and bars, fast food premises, and premises offering facilities for music and dancing; other than applications to vary hours within the Core Hours under Policy HRS1.</p> <p>(ii) Applications for other licensable activities in the Cumulative Impact Areas will be subject to other policies, and must demonstrate that they will not add to cumulative impact in the Cumulative Impact Areas.</p>
Policy OS2 applies:	Applications will be granted subject to the relevant criteria in Policies CD1, PS1, PN1 CH1 and HRS1 and other policies in this Statement, provided it is demonstrated that they will not add to cumulative impact in the Cumulative Impact.

4. Appendices

Appendix 1	Premises plans
Appendix 2	BTP and TFL statements submitted by the Police
Appendix 3	Premises history
Appendix 4	Proposed conditions
Appendix 5	Residential map and list of premises in the vicinity

Report author:	Mrs Sumeet Anand-Patel Senior Licensing Officer
Contact:	Telephone: 020 7641 2737 Email: sanandpatel@westminster.gov.uk

APPENDIX 1

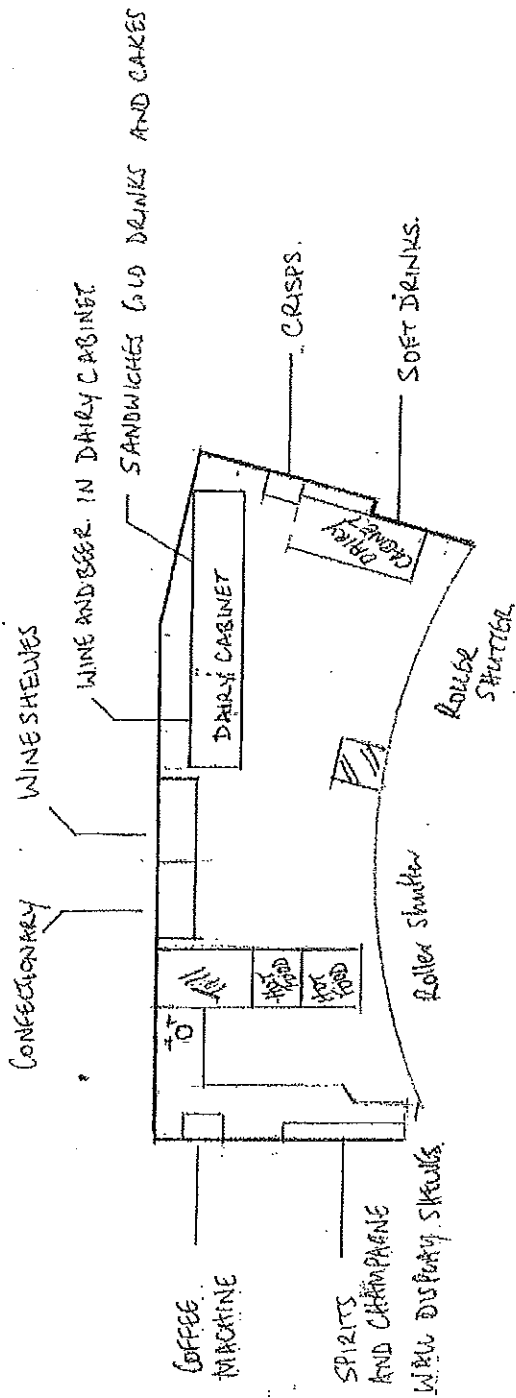

CCTV COVERAGE FOR ALL OF MAIN SHOP
 CCTV IN BOOKING HALL AREA
 ALL HAVE MORE THAN 31 DAY RECORDING FACILITY.

ESSENTIALS

LEICESTER SQUARE UNDERGROUND STATION

FLOOR PLAN

SCALE 1:100

JAN 2016

WITNESS STATEMENT**Criminal Procedure Rules, r 27. 2; Criminal Justice Act 1967, s. 9; Magistrates' Courts Act 1980, s.5B**

URN

--	--	--	--

Statement of: Myles JENNINGS

Age if under 18: Over 18 (if over 18 insert 'over 18')

Occupation: Police Constable 2957

This statement (consisting of 1 page(s) each signed by me) is true to the best of my knowledge and belief and I make it knowing that, if it is tendered in evidence, I shall be liable to prosecution if I have wilfully stated in it anything which I know to be false, or do not believe to be true.

Signature: (witness)

Date: 17 February 2016

This is a statement that relates to the impact the sale of intoxicating liquor might have on LEICESTER SQUARE tube station.

I am a police constable within the British Transport Police and have spent approximately 18 months on the Piccadilly Line Neighbourhood Policing Team. LEICESTER SQUARE is one of the stations that my team cover and we have extensive experience of policing within the station.

LEICESTER SQUARE tube station is located within the centre of what is considered the 'Entertainment District' of London. There are hundreds of bar's, restaurants, casino's and nightclubs within a short walk of the station. During the evenings, particularly between Thursday & Saturday, thousands upon thousands of people travel through LEICESTER SQUARE tube station on route to these many venues. Increasingly, the people who use LEICESTER SQUARE tube station as their destination have already consumed a high amount of alcohol prior to travelling. Once in the station, and on the wider tube network, these people can pose a high risk to both themselves and others. During the past commuters already under the influence of high levels of alcohol have caused injuries to themselves and others through falling onto live railway tracks, or falling down stairs and moving escalators. These incidents have, on more than one occasion, resulted in the closure of all or parts of the station in order for individuals to receive urgent medical treatment.

During my time policing LEICESTER SQUARE, I have been called upon to deal with several incidents in which members of staff have been verbally abused or physically assaulted by commuters within the ticket hall area of the station. The majority of suspects in these cases have been heavily intoxicated and are at the start of their night out or are on their way home following an evening of heavy drinking. There have also been several occasions where alcohol has played a major part in physical violence between commuters.

Anti-social behaviour is greatly increased during the evenings, between Thursdays and Saturdays, mainly due to people who have been drinking and then chose to travel through LEICESTER SQUARE tube station. They make it uncomfortable for other commuters and can be intimidating towards the more elderly travellers.

With the granting of an alcohol licence to the shop at LEICESTER SQUARE, I can only see the above problems becoming worse. Many people on their way out or travelling home after a night of drinking will see it as an opportunity to consume even more alcohol, resulting in more physical injuries, more assaults on staff and more physical violence between commuters. And with the launch of the 24 hour tube service approaching, the above problems along with the sale of alcohol within the station will only increase the problems already encountered by staff and police. Many people on their way home will see the opportunity to buy an alcoholic drink for the journey home and become further intoxicated, therefore increasing the risk to their personal safety and to others travelling on the network.

TFL railway byelaw 4, in short, states that it is an offence for anyone to be on the tube network while in possession of intoxicating liquor or to be on the network while unfit to travel through intoxication. Selling alcohol within the confines of the station would seem to be encouraging commuters to break the law.

WITNESS STATEMENT

Criminal Procedure Rules, r 27. 2; Criminal Justice Act 1967, s. 9; Magistrates' Courts Act 1980, s.5B

URN

93

Statement of: Jonathan Blackett

Age if under 18: Over 18

(if over 18 insert 'over 18')

Occupation: Police Sergeant

This statement (consisting of 2 page(s) each signed by me) is true to the best of my knowledge and belief and I make it knowing that, if it is tendered in evidence, I shall be liable to prosecution if I have wilfully stated in it anything which I know to be false, or do not believe to be true.

Signature: J.Blackett (witness)

Date: 18/02/2016

I am the Sergeant for the Piccadilly Line Central Team and one of the stations that we cover is Leicester Square.

Leicester Square is situated in the "entertainment district" of London and is a very busy station, especially during the evening and at weekends. There are a great number of restaurants, bars, pubs and clubs in the area, which are all a short walk from the station. Leicester Square is used by thousands of people each evening to go to these venues, increasingly the people who are travelling to these locations have drunk a high amount of alcohol prior to travelling, and more alcohol is then consumed at the venues. This poses a high risk to their own safety when travelling on the railway network and increases the risk to the staff members who work at this station, who are more likely to be subjected to abuse and violence.

I have seen first hand the dangers of people who have drunk high volumes of alcohol and then go on to the rail network, these range from falling over and not being able to walk, to falling down escalators and suffering serious injuries, to even being killed, having falling in front of a train.

Violence and public order offences are two of the highest crime types at Leicester Square station; these peak during the evening and at weekends and are more often than not fuelled by alcohol.

In my opinion, granting the licence for SHOP 1 at Leicester Square will only help increase the levels of violent and public order offences we already see at the station. I have spoken to members of the TFL staff who work there, and they fear that they will be subjected to even more abuse if the sale of alcohol is allowed. They already have to manage and look after a very challenging station, due to the already high level of drunken people travelling through. The shop is located in the booking hall which does get over crowded and is a flash point for violence and abusive behaviour. I feel that the selling of alcohol, which is in the form of glass bottles and cans means that people will have a ready made weapons to use. Both glass bottles and cans can cause very serious injuries, this poses a risk to staff, other travelling public and officers policing the station.

There is in fact Railway Byelaw 4 which TFL have in place which is a ban on carrying open containers and drinking of alcohol on there stations and trains. People who enter the station to buy alcohol will be doing so to then consume it on there journey home, there are plenty of off licences in the vicinity for people who want to drink outside. This seems to me that there is a danger of it engorging people to drink on the underground and potentially committing offences.

British Transport Police are committed to providing a safe environment for the TFL staff to work and for the public to travel on. We are facing challenging times with regards to policing resource levels and I feel this will only increase these pressures as we would see an increase in offences and need more resources to police the station.

In closing, I do not believe that this licence should be granted.

PS 1341 Jonathan Blackett, Piccadilly Line Central NPT

Signature: J.Blackett

Signature witnessed by:

WITNESS STATEMENT

Criminal Procedure Rules, r 27.2; Criminal Justice Act 1967, s. 9; Magistrates' Courts Act 1980, s.5B

URN [] [] [] []

Statement of: DAVID DELLAR

Age if under 18: OVER 18 (if over 18 insert 'over 18') Occupation: TFL STATION SUPERVISOR

This statement (consisting of page(s) each signed by me) is true to the best of my knowledge and belief and I make it knowing that, if it is tendered in evidence, I shall be liable to prosecution if I have wilfully stated in it, anything which I know to be false, or do not believe to be true.

Signature: [Signature] Date: 18 FEB 2016

Tick if witness evidence is visually recorded [] (supply witness details on rear)

MY NAME IS DAVID DELLAR AND I AM A STATION SUPERVISOR AT LEICESTER SQUARE TUBE STATION. I HAVE BEEN BASED AT THE STATION FOR ABOUT 12 YEARS. THIS STATEMENT RELATES TO THE IMPACT THAT ALCOHOL BEING SERVED WITHIN THE STATION MAY HAVE

I AM CONCERNED THAT THE SALE OF ALCOHOL WITHIN THE STATION WILL LEAD TO AN INCREASE IN THE AMOUNT OF STAFF ASSAULT THAT TAKE PLACE. PEOPLE WHO ARE ALREADY DRUNK WILL BUY MORE ALCOHOL WHICH WILL CAUSE THEM TO BECOME MORE ABUSIVE AND PHYSICALLY THREATENING TOWARDS STAFF. MANY PEOPLE WHO VERBALLY & PHYSICALLY ABUSE STAFF ARE ALREADY DRUNK SO GIVING THEM THE CHANCE TO DRINK MORE ALCOHOL WOULD POTENTIALLY INCREASE THE RATE AND SEVERITY OF THESE OCCURRING. THERE IS ALSO A HIGH RISK OF PEOPLE WHO HAVE BEEN DRINKING BECOMING INVOLVED IN FIGHTS THROUGHOUT THE STATION, WHICH POSES A RISK TO OTHER

Signature: [Signature] Signature witnessed by:

Continuation of Statement of: DAVID DELLAR Page No. 2 of

COMMUTERS ALONG WITH STAFF MEMBERS. EMPTY BOTTLES AND CANS WHICH ARE LEFT LAYING AROUND COULD POTENTIALLY BE USED AS WEAPONS.

COMMUTERS WHO CARRY ON DRINKING WHILE ON THE TUBE ARE ALSO A RISK TO THEMSELVES. THEY MAY BECOME UNSTEADY ON THEIR FEET AND COULD EASILY FALL DOWN ESCALATORS ~~ON~~ OR ONTO THE TRAIN TRACKS.

AS DRINKING ALCOHOL WITHIN THE STATION AND ON THE TUBE IS AGAINST THE LAW, HOW WOULD WE BE ABLE TO STOP PEOPLE BUYING ALCOHOL IN THE SHOP THEN DRINKING IT ON THE TRAIN?

~~OTHER~~ OTHER MEMBERS OF THE PUBLIC WOULD PROBABLY FEEL THREATENED IF PEOPLE, WHO ARE ALREADY BEING ROWDY, ARE STILL DRINKING ON THE TUBE AND BEING LOUD AND BOISTEROUS

Signature: *David Dellar*

Signature witnessed by:

Appendix 3

There is no licence or appeal history for the premises

CONDITIONS CONSISTENT WITH THE OPERATING SCHEDULE AND CONDITIONS PROPOSED BY A PARTY TO THE HEARING

When determining an application for a new premises licence under the provisions of the Licensing Act 2003, the licensing authority must, unless it decides to reject the application, grant the licence subject to the conditions which are indicated as mandatory in this schedule.

At a hearing the licensing authority may, in addition, and having regard to any representations received, grant the licence subject to such conditions which are consistent with the operating schedule submitted by the applicant as part of their application, or alter or omit these conditions, or add any new condition to such extent as the licensing authority considers necessary for the promotion of the licensing objectives.

This schedule lists those conditions which are consistent with the operating schedule, or proposed as necessary for the promotion of the licensing objectives by a responsible authority or an interested party as indicated. These conditions have not been submitted by the licensing service but reflect the positions of the applicant, responsible authority or interested party and have not necessarily been agreed

Mandatory Conditions

1. No supply of alcohol may be made at a time when there is no designated premises supervisor in respect of this licence.
2. No supply of alcohol may be made at a time when the designated premises supervisor does not hold a personal licence or the personal licence is suspended.
3. Every supply of alcohol under this licence must be made or authorised by a person who holds a personal licence.
4.
 - (1) The premises licence holder or club premises certificate holder must ensure that an age verification policy is adopted in respect of the premises in relation to the sale or supply of alcohol.
 - (2) The designated premises supervisor in relation to the premises licence must ensure that the supply of alcohol at the premises is carried on in accordance with the age verification policy.
 - (3) The policy must require individuals who appear to the responsible person to be under 18 years of age (or such older age as may be specified in the policy) to produce on request, before being served alcohol, identification bearing their photograph, date of birth and either—
 - (a) a holographic mark, or
 - (b) an ultraviolet feature.
- 5(i) A relevant person shall ensure that no alcohol is sold or supplied for consumption on or off the premises for a price which is less than the permitted price.
- 5(ii) For the purposes of the condition set out in paragraph 5(i) above -

(a) "duty" is to be construed in accordance with the Alcoholic Liquor Duties Act 1979;

(b) "permitted price" is the price found by applying the formula -

$$P = D + (D \times V)$$

Where -

- (i) P is the permitted price,
- (ii) D is the amount of duty chargeable in relation to the alcohol as if the duty were charged on the date of the sale or supply of the alcohol, and
- (iii) V is the rate of value added tax chargeable in relation to the alcohol as if the value added tax were charged on the date of the sale or supply of the alcohol;

(c) "relevant person" means, in relation to premises in respect of which there is in force a premises licence -

- (i) the holder of the premises licence,
- (ii) the designated premises supervisor (if any) in respect of such a licence, or
- (iii) the personal licence holder who makes or authorises a supply of alcohol under such a licence;

(d) "relevant person" means, in relation to premises in respect of which there is in force a club premises certificate, any member or officer of the club present on the premises in a capacity which enables the member or officer to prevent the supply in question; and

(e) "value added tax" means value added tax charged in accordance with the Value Added Tax Act 1994.

5(iii). Where the permitted price given by Paragraph 5(ii)(b) above would (apart from this paragraph) not be a whole number of pennies, the price given by that sub-paragraph shall be taken to be the price actually given by that sub-paragraph rounded up to the nearest penny.

- 5(iv). (1) Sub-paragraph 5(iv)(2) below applies where the permitted price given by Paragraph 5(ii)(b) above on a day ("the first day") would be different from the permitted price on the next day ("the second day") as a result of a change to the rate of duty or value added tax.
- (2) The permitted price which would apply on the first day applies to sales or supplies of alcohol which take place before the expiry of the period of 14 days beginning on the second day.

Conditions proposed by the Environmental Health and agreed by the applicant

6. All sales of alcohol for consumption off the premises shall be in sealed containers only, and shall not be consumed on the premises.

7. All tills shall automatically prompt staff to ask for age verification identification when presented with an alcohol sale.

8. Outside of the hours authorised for the sale of alcohol, all alcohol within the trading area is to be secured behind locked grilles/screens or secured behind locked cabinet doors so as to prevent access to the alcohol by both customers and staff.
9. No super-strength beer, lagers or ciders of 5.5% ABV (alcohol by volume) or above shall be sold at the premises except for premium beers and ciders sold in glass bottles.
10. No more than 15% of the sales area to be used at any one time for the sale, exposure for sale, or display of alcohol.
11. There shall be no self-service of spirits on the premises except for spirit mixtures below 5.5% Alcohol by Volume.
12. Prominent signage indicating the permitted hours for the sale of alcohol shall be displayed so as to be visible before entering the premises, where alcohol is on public display, and at the point of sale.
13. No noise shall emanate from the premises nor vibration be transmitted through the structure of the premises which gives rise to a nuisance.
14. A challenge 25 proof of age scheme shall be operated at the premises where the only acceptable forms of identification are recognised photographic identification cards, such as a driving licence, passport or proof of age card with the PASS Hologram.
15. The premises shall install and maintain a comprehensive CCTV system as per the minimum requirements of the Westminster Police Licensing Team. All entry and exit points will be covered enabling frontal identification of every person entering in any light condition. The CCTV system shall continually record whilst the premises is open for licensable activities and during all times when customers remain on the premises. All recordings shall be stored for a minimum period of 31 days with date and time stamping. Viewing of recordings shall be made available immediately upon the request of Police or authorised officer throughout the preceding 31 day period.
16. A staff member from the premises who is conversant with the operation of the CCTV system shall be on the premises at all times when the premises are open to the public. This staff member shall be able to show Police recent data or footage with the absolute minimum of delay when requested.
17. A diary log shall be kept detailing all refused sales of alcohol. The log should include the date and time of the refused sale and the name of the member of staff who refused the sale. The log shall be available for inspection at the premises by the police or an authorised officer of the City Council at all times whilst the premises are open.
18. The Licence will have no effect until the premises have been assessed as satisfactory by the Environmental Health Consultation Team and this condition has been removed from the Licence.



Leicester Square Station, Unit1, Essential

City of Westminster

APPENDIX 5

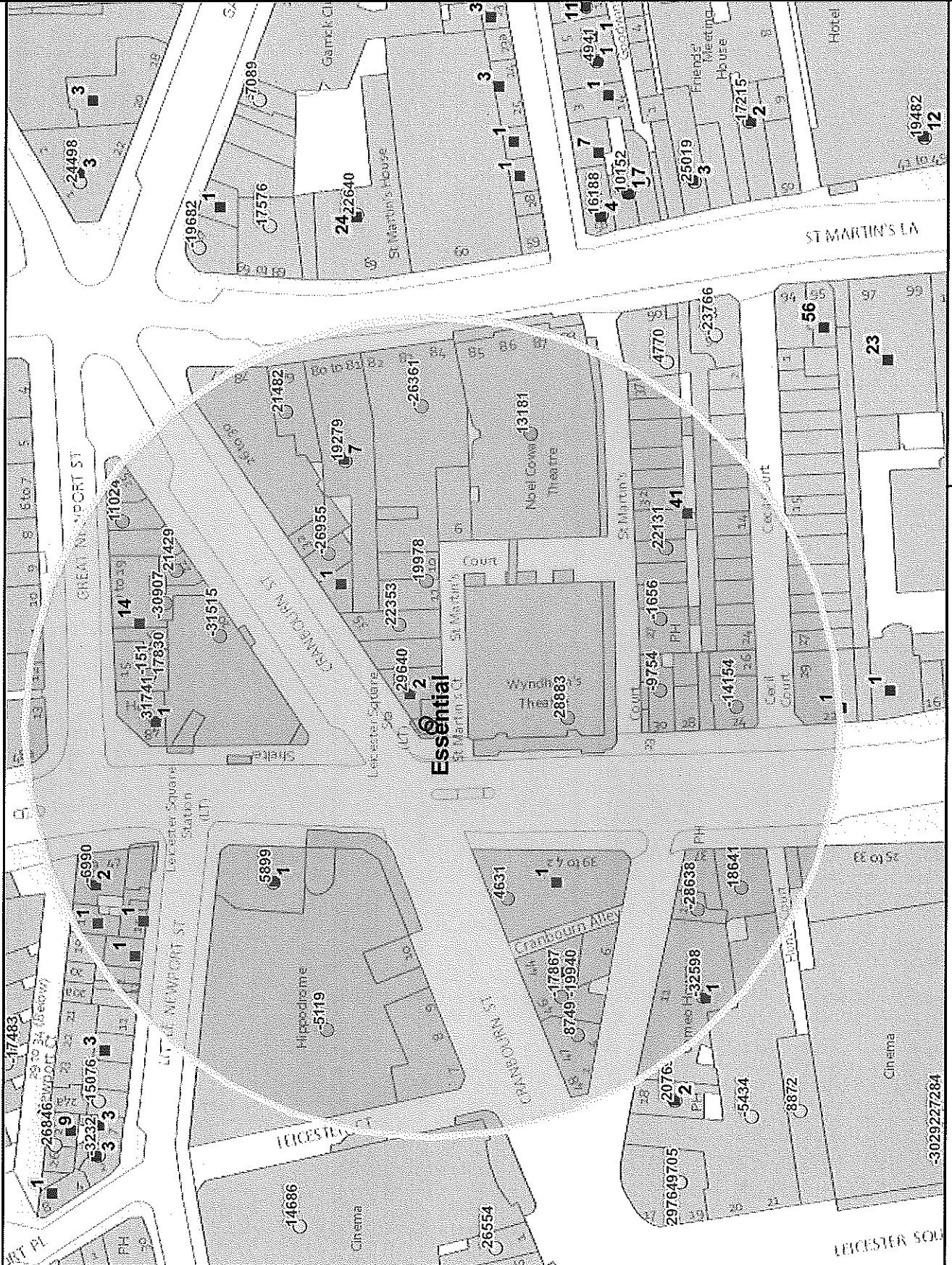

Residential / Proposed Residential	76
Under Construction	Not Known
Other Uses	Not Known
Proportion Residential of all Uses	Not Known

This product includes mapping data licensed from Ordnance Survey with the permission of the Controller of Her Majesty's Stationery Office. © Crown copyright and/or database right 2013. All rights reserved. Licence number: 1 400040507

Data Source: Uniform Database
Date: 29/03/2016

10 Meters

Premises within 75 metres of: Unit1, Leicester Square Station.

p / n	Name of Premises	Premises Address	Opening Hours
-6990	Longji	Ground 47 Charing Cross Road London WC2H 0AN	Monday to Sunday 11:00 - 23:30
21429	Cafe Aroma	22 Cranbourn Street London WC2H 7AA	Monday to Thursday 10:00 - 03:00 Friday to Saturday 10:00 - 04:00 Sunday 12:00 - 23:00
22131	J Sheekey	28-32 St Martin's Court London WC2N 4AL	Monday to Saturday 10:00 - 01:30 Sunday 12:00 - 00:00
28883	Wyndhams Theatre	Wyndhams Theatre Charing Cross Road London WC2H 0DA	Monday to Sunday 09:00 - 01:00
-5119	Hippodrome Casino	The Hippodrome 10 - 14 Cranbourn Street London WC2H 7JH	Monday to Sunday 00:01 - 00:00
19279	Pizza Express	Ground Floor 80-81 St Martin's Lane London WC2N 4AA	Monday to Saturday 10:00 - 00:30 Sunday 12:00 - 00:00
19978	Cafe Koha Bar	10-11 St Martin's Court London WC2N 4AJ	Sunday 10:00 - 02:30 Monday to Saturday 10:00 - 04:30
21482	Steak & Co	Ground Floor 79 St Martin's Lane London WC2N 4AA	Monday to Saturday 10:00 - 23:30 Sunday 12:00 - 23:00
-14154	Byron	24 Charing Cross Road London WC2H 0DT	Monday to Saturday 10:00 - 00:30 Sunday 12:00 - 00:00
17830	Pizza Rico	15-18 Great Newport Street London WC2H 7JG	Monday to Sunday 07:00 - 00:30
29840	The Brewmaster	37 Cranbourn Street London WC2H 7AD	Friday to Saturday 10:00 - 00:00 Monday to Thursday 10:00 - 23:30 Sunday 11:00 - 23:00
-19940	Noodle Stop	Ground 44-46 Cranbourn Street London WC2H 7AN	Monday to Saturday 10:00 - 05:00 Sunday 12:00 - 05:00
-1656	Round Table Public House	26-27 St Martin's Court London WC2N 4AL	Friday to Saturday 07:00 - 00:00 Sunday 07:00 - 22:50 Monday to Thursday 07:00 - 23:30 Sundays before Bank Holidays 07:00 - 23:30
-26955	Westminster Noodle Bar	Ground Floor 33 Cranbourn Street London WC2H 7AD	Sunday to Thursday 10:00 - 02:00 Friday to Saturday 10:00 - 05:00
4531	Cafe Fiori	42 Cranbourn Street London WC2H 7JH	Monday to Saturday 10:00 - 05:00 Sunday 12:00 - 05:00
13181	Noel Coward Theatre	Noel Coward Theatre 85-89 St Martin's Lane London WC2N 4AU	Monday to Sunday 09:00 - 01:00
-30907	Enbocote Tortilla	21 Cranbourn Street London WC2H 7AA	Monday to Sunday 23:00 - 05:00
-28638	Bear & Staff Public House	10-12 Bear Street London WC2H 7AS	Friday to Saturday 07:00 - 00:00 Sunday 07:00 - 00:00 Sundays before Bank Holidays 07:00 - 00:00 Monday to Saturday 07:00 - 00:30 Sunday 07:00 - 22:30 Monday to Thursday 07:00 - 23:30
5889	PizzaExpress	43 Charing Cross Road London WC2H 0AP	Sunday 07:00 - 00:00 Monday to Saturday 07:00 - 00:30 Sundays before Bank Holidays 07:00 - 00:30
11024	Spasofti House	24 Cranbourn Street London WC2H 7AA	Monday to Saturday 10:00 - 00:30 Sunday 12:00 - 00:00
31741	The Porcupine Public House	48 Charing Cross Road London WC2H 0DS	Friday to Saturday 07:00 - 00:00 Sunday 07:00 - 00:00 Sundays before Bank Holidays 07:00 - 00:00 Monday to Saturday 07:00 - 00:30 Sunday 07:00 - 22:30 Monday to Thursday 07:00 - 23:30
-32598	The Zoo Bar And Club	Basement And Ground Floor Cameo House 13-17 Bear Street London WC2H 7AQ	Sunday 09:00 - 01:00 Monday to Saturday 09:00 - 02:30 Sundays before Bank Holidays 09:00 - 02:30 Monday to Saturday 09:00 - 03:30
-17867	Cork And Bottle Wine Bar	Basement 44-46 Cranbourn Street London WC2H 7AN	Monday to Saturday 10:00 - 00:30 Sunday 12:00 - 00:00
-31515	Angus Steak House	Ground Floor 20 Cranbourn Street London WC2H 7AA	Sunday 10:00 - 00:00 Monday to Saturday 10:00 - 01:00 Sundays before Bank Holidays 10:00 - 01:00
18641	K. S. Food And Wine	Ground Floor 35 Charing Cross Road London WC2H 0AT	Monday to Sunday 08:00 - 05:00
22353	Piazza Restaurant	35 Cranbourn Street London WC2N 4AJ	Monday to Saturday 10:00 - 00:30 Sunday 12:00 - 00:00
-26381	Brown's Restaurant	82-84 St Martin's Lane London WC2N 4AG	Monday to Sunday 08:00 - 00:00 Sunday to Wednesday 08:00 - 00:30 Thursday to Saturday 08:00 - 01:30
-9754	Gaby's Continental Bar	30 Charing Cross Road London WC2H 0DB	Monday to Saturday 10:00 - 00:30 Sunday 12:00 - 00:00
-151	Abeno Teo Japanese Restaurant	15-18 Great Newport Street London WC2H 7JG	Sunday 12:00 - 22:30 Monday to Wednesday 12:00 - 23:00 Wednesday to Saturday 12:00 - 23:30
8749	Rimini Coffee Bar	Basement And Ground Floor West 47 Cranbourn Street London WC2H 7AN	Monday to Thursday 10:00 - 02:00 Monday to Thursday 10:00 - 02:00 Friday to Saturday 10:00 - 03:00 Friday to Saturday 10:00 - 04:00 Sunday 12:00 - 01:30 Sunday 12:00 - 02:00

If you have any queries about this report or wish to inspect one of the background papers please contact the report author.

Background Documents – Local Government (Access to Information) Act 1972

1	Licensing Act 2003	N/A
2	City of Westminster Statement of Licensing Policy	January 2016
3	Amended Guidance issued under section 182 of the Licensing Act 2003	March 2015